

DAS RHEINGAU

Rheingaustraße 29/30, 12161 Berlin-Schöneberg



DAS RHEINGAU

Rheingaustraße 29/30, 12161 Berlin-Schöneberg

Number of Apartments **69**

Year built **2025-27**

Available from **2027**

Elevator

Parking spaces

Cellar

PROJECT

With the new building ensemble DAS RHEINGAU in Berlin-Friedenau, a residential project is being created that harmoniously combines classic architecture and contemporary living comfort. At Rheingaustraße 29-30, BAUWERT AG, together with BONANNI Architekten, is realizing a new building ensemble that preserves values and shapes the future. DAS RHEINGAU comprises 69 condominiums with 2 to 5 rooms. Generous ceiling heights, premium materials, and finely coordinated details characterize the appearance. A striking natural stone base, white wooden windows, and textured plaster surfaces lend the facade a classic elegance. Balconies, loggias, terraces, and private gardens create light-filled living spaces with individual character.

The interior reflects the attention to detail: oak parquet flooring, underfloor heating, porcelain stoneware from Fiandre, Mirage, and Rako, and elegant fixtures from renowned manufacturers stand for quality and durability. Sustainable energy through solar modules, green roofs, and e-mobility solutions round out the concept. DAS RHEINGAU is an ensemble for people who value architectural clarity, comfort, and durability – a piece of stylish Berlin, designed to last for generations.

LOCATION

Berlin-Friedenau is considered one of Berlin's most charming residential areas – quiet, green, and characterized by cultural vibrancy. Narrow, tree-lined streets, front gardens, and historic buildings give the neighborhood its distinctive atmosphere. Neighborhood spirit, quality of life, and urban elegance combine here.

Around DAS RHEINGAU, cafés, delicatessens, and weekly markets invite you to explore, while Schlosstraße offers a variety of shopping opportunities. Artistic venues and traditional restaurants characterize the neighborhood's flair. Thanks to the S-Bahn and U-Bahn, buses, and the city highway, the City West can be reached in just a few minutes. A home at DAS RHEINGAU means living in the heart of Berlin – and at the same time feeling at home in a small, idyllic world.

DAS RHEINGAU

Rheingaustraße 29/30, 12161 Berlin-Schöneberg

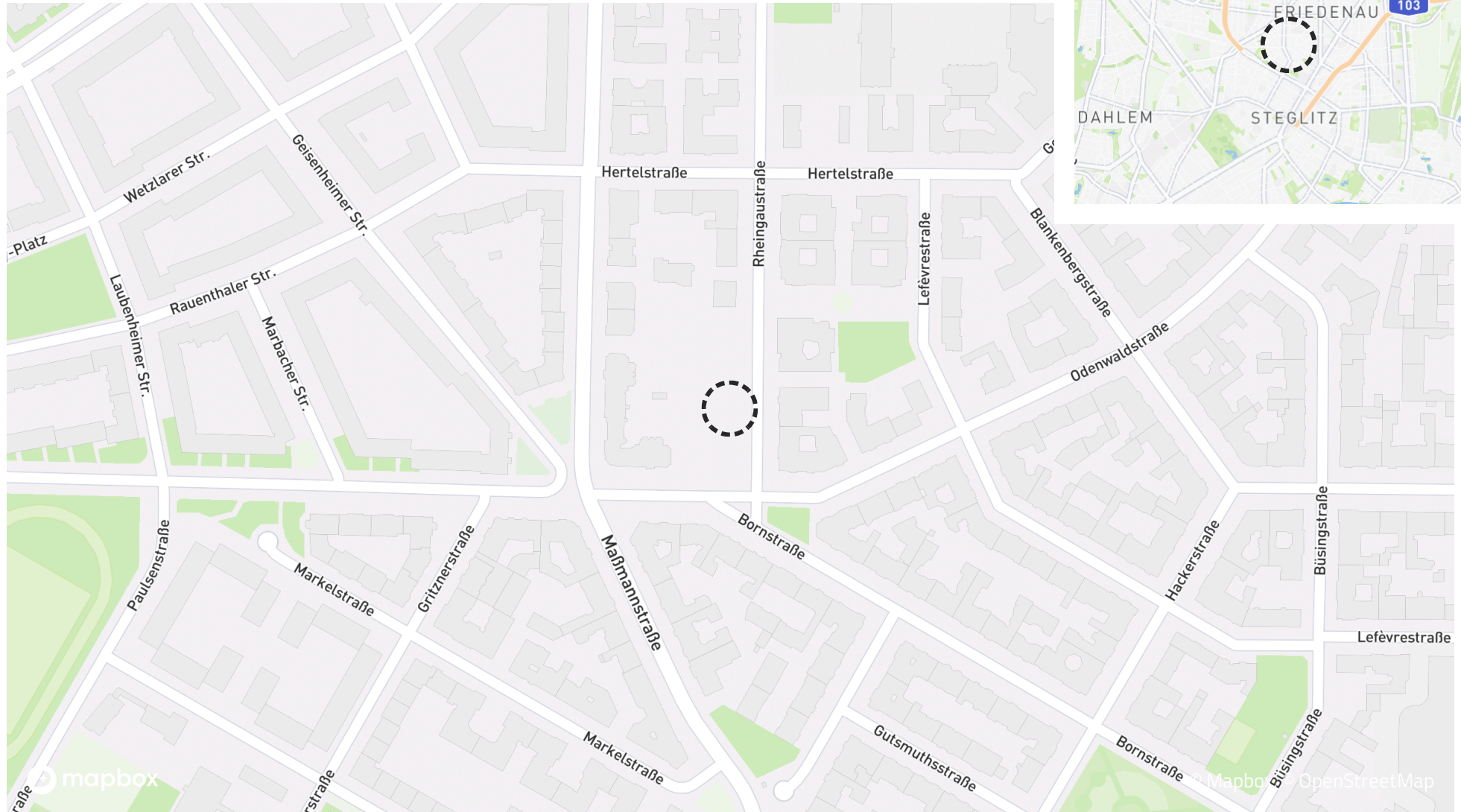

DAS RHEINGAU



House view



House view



Apartment with balcony



Garden area



Facade detail



House entrance area



Terrace ground floor apartment

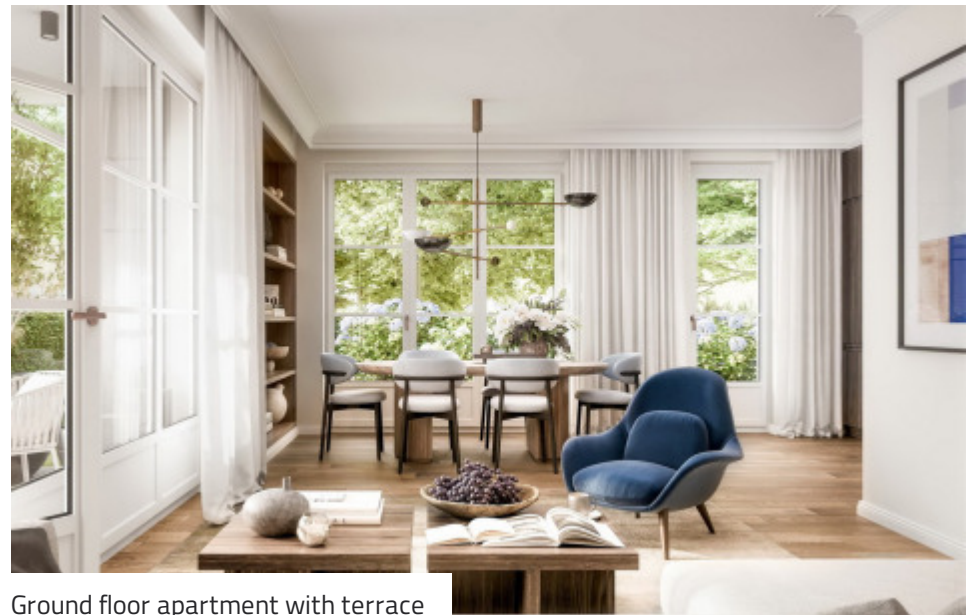

Ground floor apartment with terrace

DAS RHEINGAU

House entrances TH1, TH2 and TH3

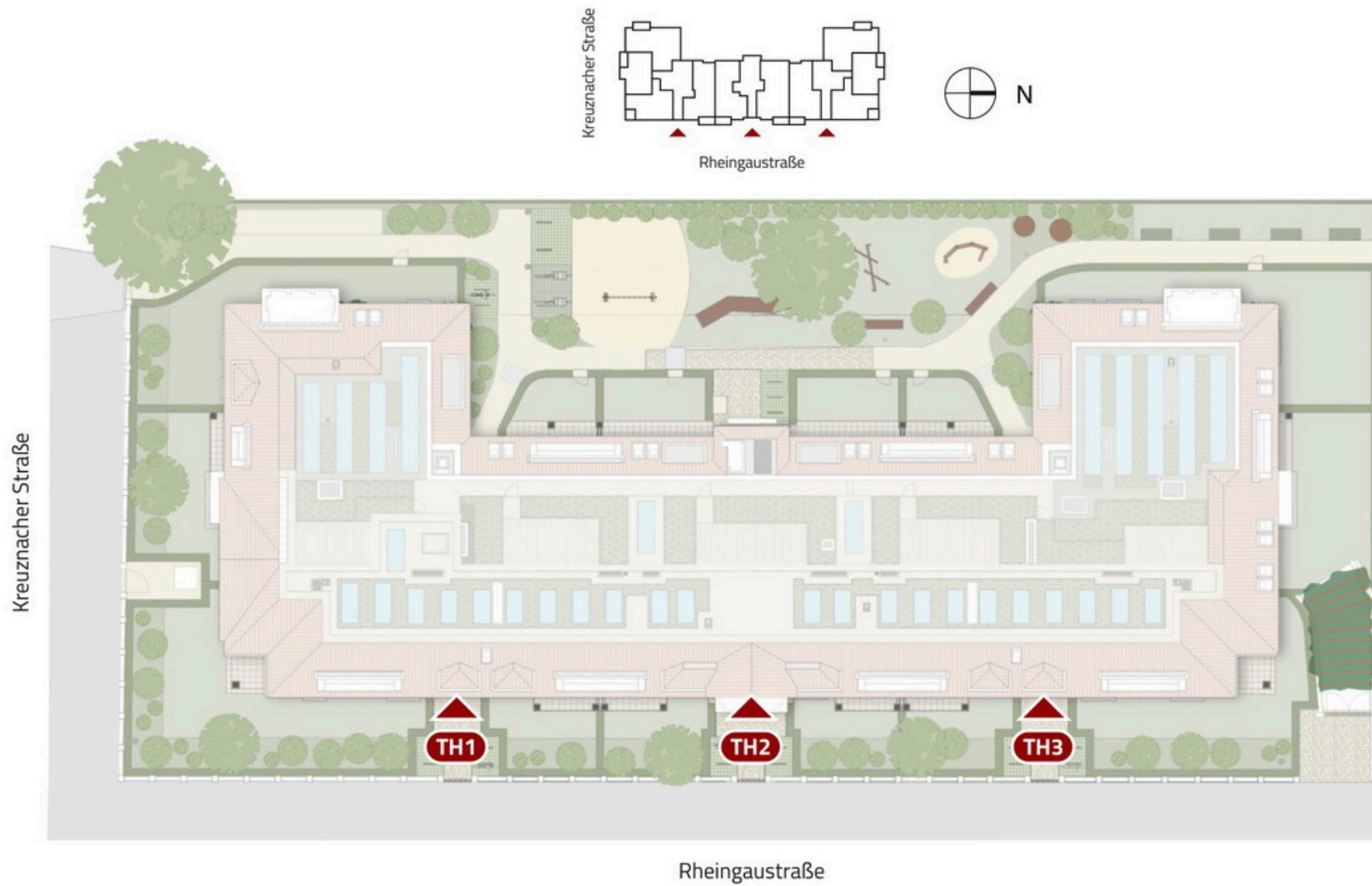





The new building ensemble is divided into three entrance areas, each with separate staircases and elevators.

DAS RHEINGAU

Rheingaustraße 29/30, 12161 Berlin-Schöneberg

CONDOMINIUMS (PERSONAL USE)

Unit	House entrance	Provider ID	Floor	Rms.			Areas	Purchase price				
# 101	TH1	RGS-101	Ground floor	3	2	1	84 m ²	942.900 €	1	✓	✓	Details
# 124	TH2	RGS-124	2nd floor	2	1	1	56 m ²	675.900 €	1	✓	✓	Details
# 201	TH2	RGS-201	Ground floor	4	3	2	107 m ²	1.089.900 €	2	✓	✓	Details
# 212	TH2	RGS-212	1st floor	4	3	2	108 m ²	1.149.900 €		✓	✓	Details
# 221	TH2	RGS-221	2nd floor	3	2	2	85 m ²	978.900 €	1	✓	✓	Details
# 312	TH2	RGS-312	1st floor	4	3	2	112 m ²		1	✓	✓	reserved
# 325	TH2	RGS-325	2nd floor	3	2	1	83 m ²	944.900 €	1	✓	✓	Details

DAS RHEINGAU

Rheingaustraße 29/30, 12161 Berlin-Schöneberg

PROVIDER

BAUWERT AG

Kurfürstendamm 21
10719 Berlin



SALES TEAM

☎ +49 30 832115555

✉ vertrieb@bauwert.de

NOTES

Illustrations and visualizations shown (interior and exterior views) may differ from actual planned or executed construction features (walls, windows, doors, flooring and wall coverings, facades, colors, roofs, balconies and terraces, plants, etc.) and do not constitute a guarantee of specific characteristics. Floor plans shown are schematic and cannot be used to derive exact dimensions. Drawings may differ from the actual condition (wall thicknesses, door details, sanitary fixture placement, etc.). Furniture shown is only included in the purchase price if explicitly described as part of the purchase agreement.



estater-Project-ID: 241895

estater.de/en/id/241895